

Q

Troubleshooting When Your Sprayer Doesn't Raise The Pressure.



First check!!

Please take off the suction hose from inlet valve set(①) and put your hand on the inlet valve to check if the suction valve sucks or not(②).

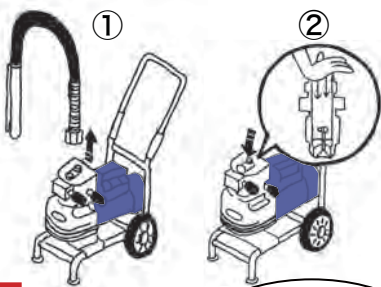

If it sucks

Main reason and solution for the trouble.

Reason: Air left in the suction hose.

Please check if there is any crack on the suction hose and the fitting is not released. When the fitting is not tighten enough, inlet valve sucks air and it disturbs pressure rise.

If the pressure still doesn't raise after retightening

Clogging in suction hose suction filter

Please check the clogging and clean up.

If it doesn't suck

70% of troubles are caused sticking of suction valve.

Reason: The paint is stuck in the suction valve

Solution

- ① Turn on the switch, open the air relief valve and turn the pressure knob to high pressure.
- ② Add the small amount of paint thinner and push the suction valve by a screwdriver to remove the sticking.

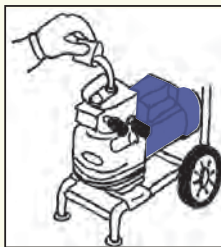

If the solution didn't work

◆ Suction valve has been damaged.

Please check the suction valve and exchange it if it has been damaged.

◆ Discharge valve has problem. (Airless hose is fluctuating etc.)

Please check if the spring in the discharge valve is not broken or not.

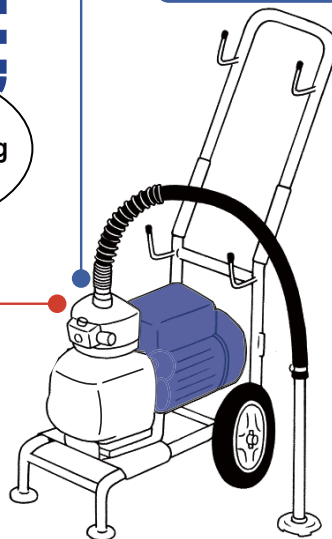

Please also check airless oil!

Enough airless oil in the pump? Please check the oil volume with oil gauge and add the oil to the gauge line.

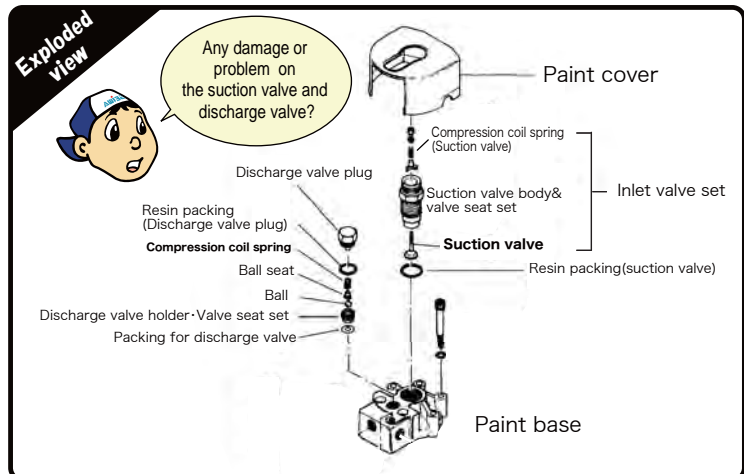

◆ Please feel free to ask us if you have question ◆